

autonumis

Popular & Premier Cooler Single Integral Unit



User & Installation Guide

This guide contains instructions for
Autonumis' Single door model
Back-bar bottle coolers.

Serial Number:										
----------------	--	--	--	--	--	--	--	--	--	--

↑ Model

Contents

Installation	02
General Operation	02
Controls	03
Routine Maintenance	04
Repairs	04
End of Life Disposal	04
Spares Order	05
Spares Identification	06
Wiring Diagram: Popular & Premier	07
Wiring Diagram: Popular & Premier Ecohill	08
Your Notes	09

Installation

Store the unit upright. If the unit has been stored or transported on its back, front or sides then it must be placed upright for at least an hour before switching on. Place the unit on an even floor as far away as possible from any source of heat.

Note: Do not move unit by lifting either the door or door handle as this may cause damage to the cabinet.

Please ensure the correct aperture size is made available for this unit:

Space Required

All dimensions exclude door handle

	Height	Width	Depth
Single Unit	925mm	530mm	525mm

The correct aperture size should give a gap of approximately 25mm between the top of the cabinet and the underside of the back bar and between the back of the unit and the wall. Poor ventilation due to insufficient aperture size is likely to cause: reduced cooling; icing up; Premature compressor failure.

Unit Dimensions

All dimensions exclude door handle

	Height	Width	Depth
Single Unit	900mm	525mm	500mm

General Operation

The cabinet door should remain firmly closed during normal operation. This prevents warm moist air entering and creating frost within the cabinet. If the cabinet is left open for extended periods ice will form. This will prevent cooling and the machine will then require defrosting (see page 03).

The unit should be left switched on, and should not be switched off between trading sessions. The unit is designed to operate in an ambient temperature range of 6°C -25°C, however for short periods of time (up to 8 hours) the unit will operate normally at 32°C. The cabinet is designed to chill product in sealed containers only i.e. bottles, cans etc. It is not recommended that glasses of drink or similar are placed in the unit for cooling.

Controls



The thermostat control is situated inside the cabinet on the back panel. Refrigeration is switched on and off at the mains supply. The light is controlled independently by using the toggle switch provided at the front of the unit.

Warning: If the supply cord is damaged, the manufacturer, its service agent or similarly qualified person must replace it, in order to avoid a hazard.

Electronic Thermostat Control

To set the desired temperature:

Press the  button (the current set temperature is now displayed).

Then press the  or  button to modify the displayed value.

Finally press the  button to store the value and exit the adjustment. If no more buttons are pressed within 10 seconds then the display will once more show the current internal temperature of the unit.

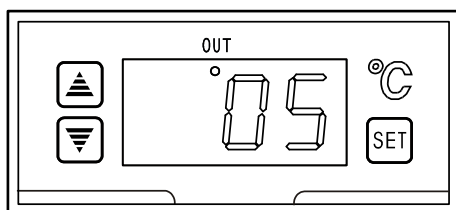

Note: Setting the unit at a colder thermostat setting will not make the unit cool down faster. This unit has been installed with an automatic defrost system to prevent the build-up of ice on interior panels. In the unlikely event of an ice build-up; switch off the unit and allow several hours for the ice to melt; wipe the inside of the unit with an absorbent cloth and dry; then restart the unit.

Routine Maintenance

Wipe clean the inside of the cabinet once a week using a damp cloth. It is recommended that the condenser is cleaned free of dirt and grime approximately every 6 months. The condenser is accessed from the rear of the machine and is the silver coloured object with metal 'fins' situated under the fan on the refrigeration components deck. Failure to keep the condenser clean will reduce the refrigeration performance of the unit.

Repairs

Warning: Ensure unit is switched off at the mains before attempting the following maintenance and repair procedures.

Lamp Replacement:

Open the front door and remove the lamp cover. This is achieved by slightly compressing the cover and lowering from its holder.

Twist the lamp from its socket and remove from the cabinet.

Reverse the procedure to fit new lamp.

Starter replacement:

Open the front door.

Starter is located at top right hand corner of inner cabinet. Twist anti-clockwise to remove.

Twist new starter clockwise into position.

End of life disposal

This unit contains a refrigerant gas and therefore must be disposed of responsibly.

To Order Spares

Find out the 'Diagram Number' of the spare(s) wanted from the exploded diagram below.

Refer to the parts Identification list (right) and find the Description' of the spare(s).

Find out the 'Serial Number' & 'Variant Number' of your unit. These are shown on the serial label (a metallic label located on the inside left wall of the cabinet) and repeated on the front of this guide.

Telephone our Sales Department on 01666 502641 with this information.

Spares Policy

The recommended spares for this unit are indicated in the diagram below. These parts will be made available for a period not less than five years after a machine has ceased to be produced or a change has been introduced. Where a change of part results in a lack of interchangeability, the old part will continue to be available for five years. Where a change of part or assembly of parts retains interchangeability, the company reserves the right to supply the new part or assembly only.

Diagram Number		Description
1		Door seal
2		Evaporator Fan
3		Light Tube
4		Thermostat
5		Lamp Starter
6		Door handle
7		Evaporator
8		Light Diffuser
9		Shelf clip
10		Door bush
11		Door black metal Right
12		Hinge plate
13		Shelf
14		Light Switch
15		Bottom Shelf
16		Condenser & Fan, Compressor, Condensate Pot, Drier, Choke

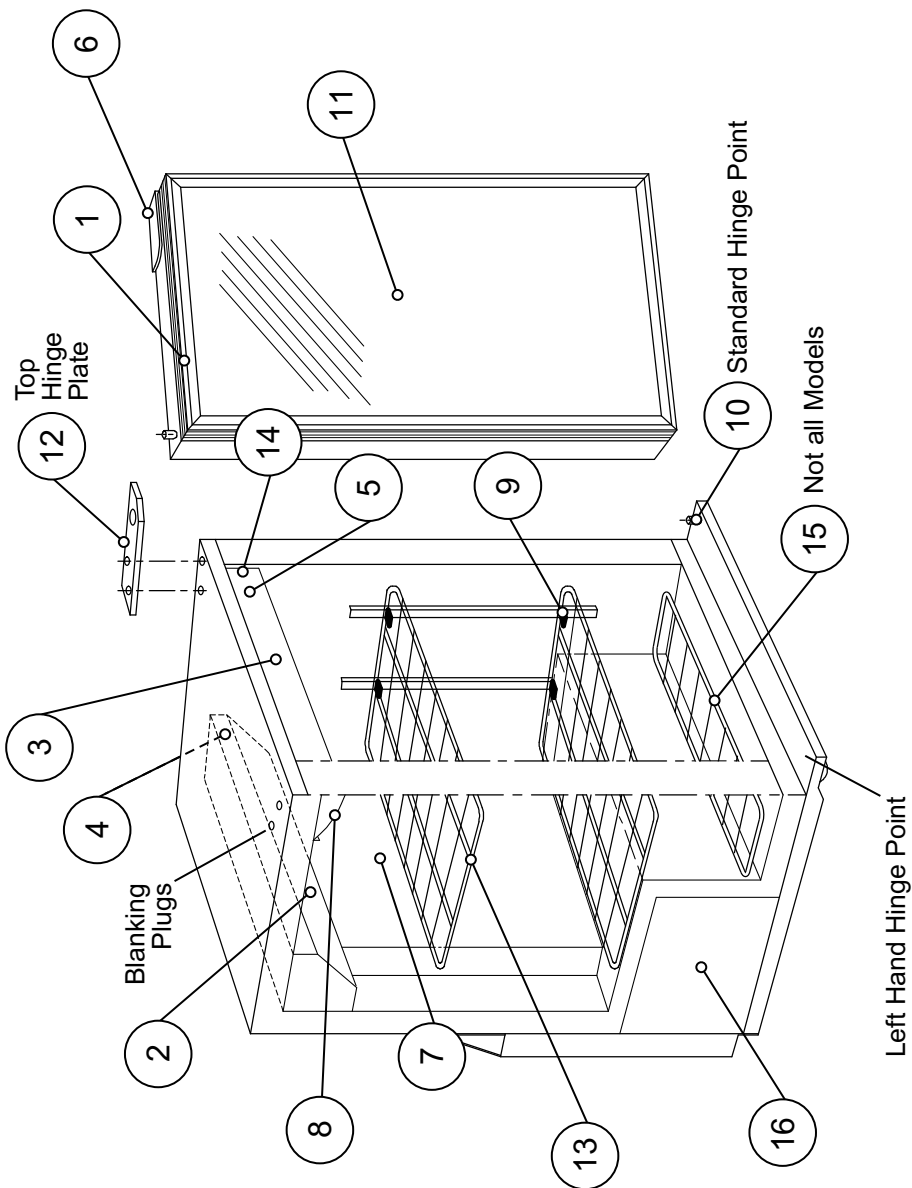

Wiring Diagram Popular & Premier single units

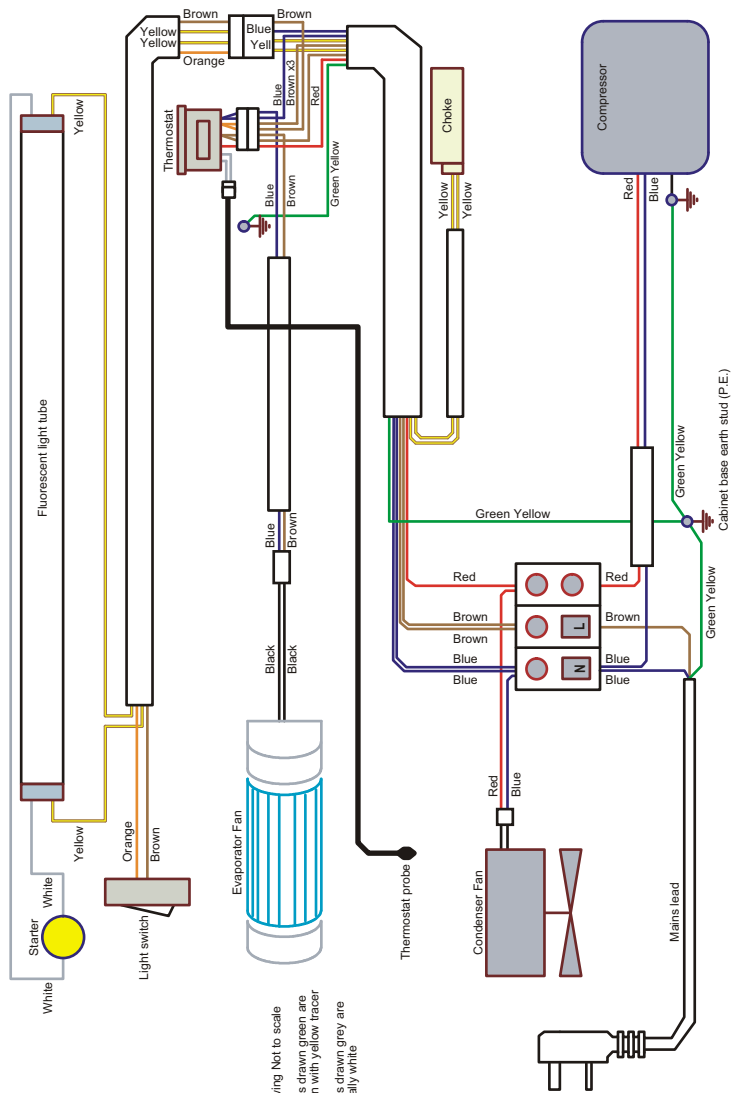

Drawing Not to scale
 Wires drawn green are
 green with yellow tracer
 Wires drawn grey are
 actually white



Wiring Diagram Ecochill single units

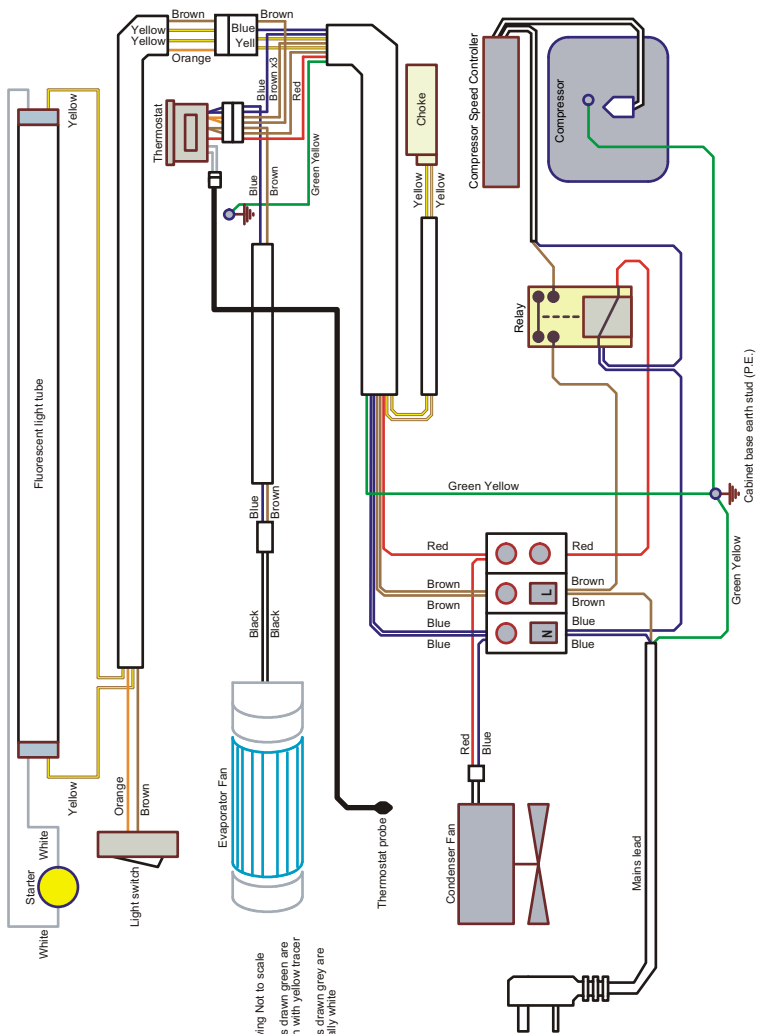

Drawing Not to scale
 Wires drawn green are green with yellow tracer
 Wires drawn grey are actually white

Notes

Notes

autonumis

Autonumis Ltd, Cirencester Rd,
Tetbury, Gloucestershire.
GL8 8SA United Kingdom
Tel +44 (0) 1666 502641
Fax +44 (0) 1666 504397